



CALCULATED
ATW
CHECKED
JCH

TYPICAL SECTIONS
PROPOSED RAPID RUN RD AND SUNSET AVE

LICK RUN CONNECTOR

* OR AS SHOWN IN CROSS SECTIONS

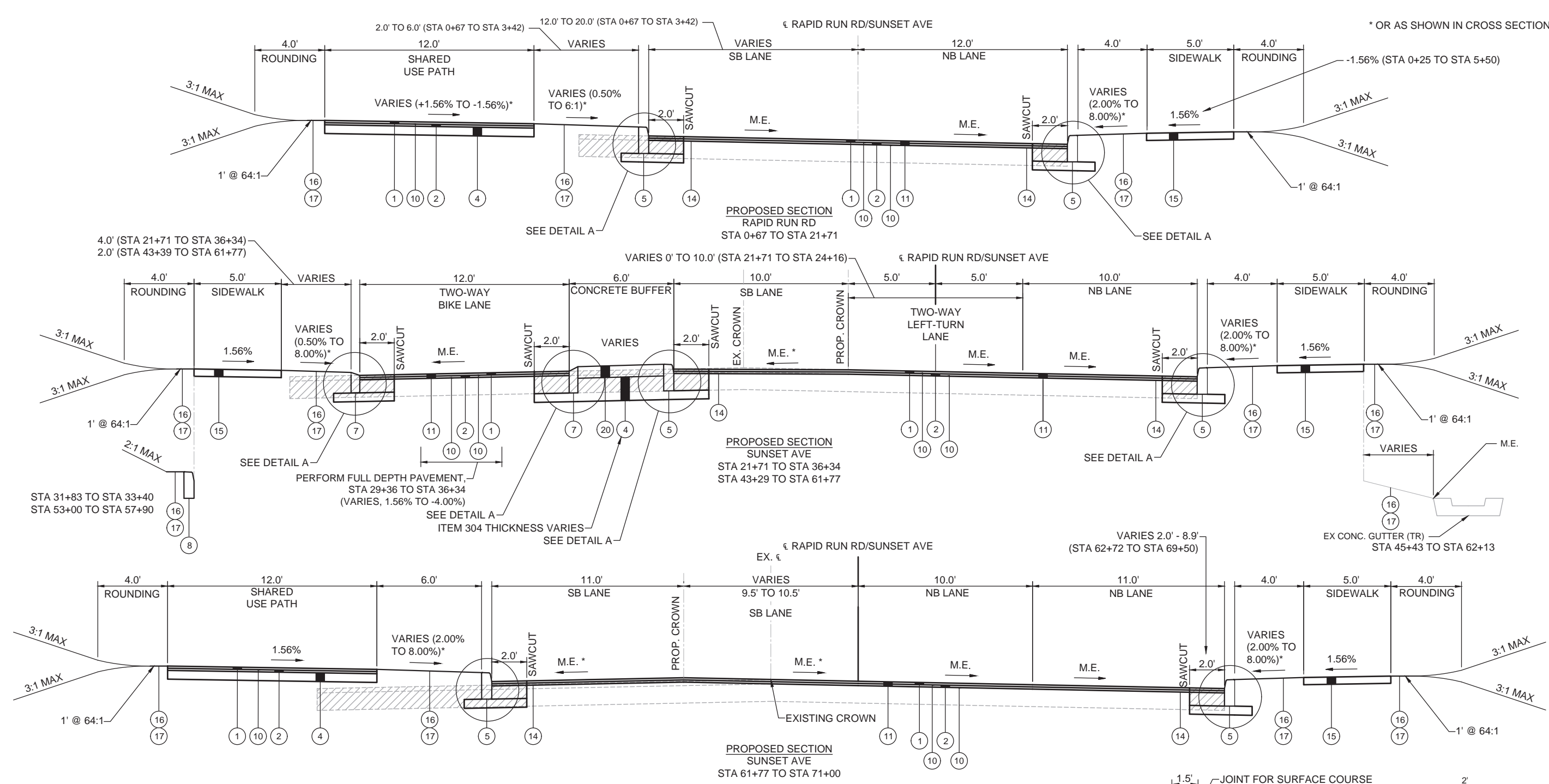

- (A) EX. ± 3" ASPHALT PAVEMENT
- (B) EX. ± 12" CONCRETE OR ASPHALT PAVEMENT
- (C) EX. ± 12" CONCRETE PAVEMENT
- (D) EX. CURB
- (E) EX. SIDEWALK
- ITEM 202 - PAVEMENT REMOVED

- ① ITEM 442 - 1.5" ASPHALT CONCRETE SURFACE COURSE, 12.5 MM, TYPE A (448)
- ② ITEM 442 - 1.5" ASPHALT CONCRETE INTERMEDIATE COURSE, 9.5 MM, TYPE A (448)
- ③ ITEM 305 - 9" CONCRETE BASE, CLASS QC 1P
- ④ ITEM 304 - 6" AGGREGATE BASE
- ⑤ ITEM 609 - CURB, TYPE 6, AS PER PLAN (CURB, TYPE S-1, DWG. NO. C103)
- ⑥ ITEM 609 - CURB, TYPE 10

- LEGEND**
- ⑦ ITEM 609 - CURB, ODOT TYPE 10-A, AS PER PLAN
 - ⑧ ITEM 609 - CURB, TYPE 7
 - ⑨ ITEM 452 - 8" NON-REINFORCED CONCRETE PAVEMENT, CLASS QC 1P
 - ⑩ ITEM 407 - NON-TRACKING TACK COAT
 - ⑪ ITEM 254 - PAVEMENT PLANING, ASPHALT CONCRETE (2.5" TYP., 0.25" MIN TO 3.5" MAX)
 - ⑫ ITEM 204 - SUBGRADE COMPACTION

- ⑬ ITEM 204 - PROOF ROLLING
- ⑭ ITEM 422 - AGGREGATE SINGLE CHIP SEAL, TYPE A (SEE LAP JOINT DETAIL)
- ⑮ ITEM 609 - 4" CONCRETE WALK
- ⑯ ITEM 659 - SEEDING AND MULCHING
- ⑰ ITEM 659 - 4" TOPSOIL
- ⑱ ITEM 517 - RAILING (CONCRETE PARAPET WITH TWIN STEEL TUBE RAILING), AS PER PLAN
- ⑲ ITEM 601 - PAVED GUTTER, MISC.: CONCRETE GUTTER (DETAIL TO BE PROVIDED AT FUTURE SUBMITTAL)

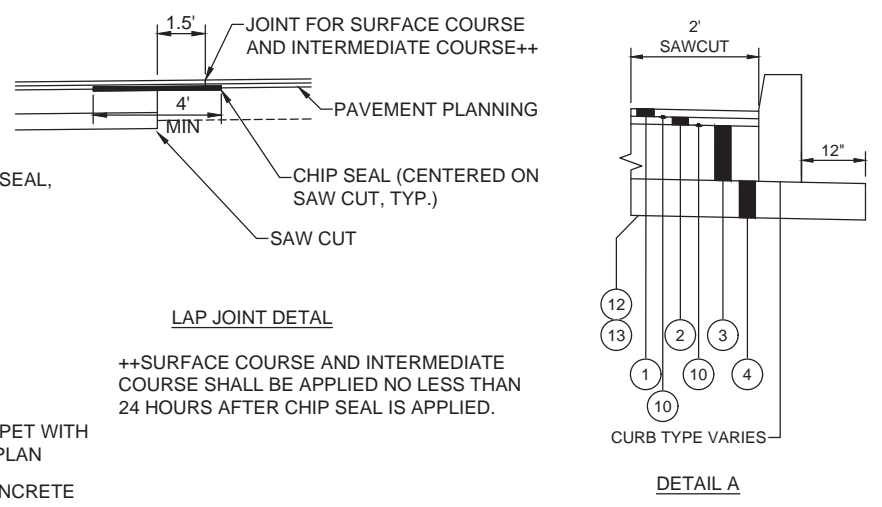

++SURFACE COURSE AND INTERMEDIATE COURSE SHALL BE APPLIED NO LESS THAN 24 HOURS AFTER CHIP SEAL IS APPLIED.

S:\CIN\3700--3799\3731\006\Drawings\CAD\Civil_3d\SheetsPlan\LRC_GY_002.dwg 18-Jul-25 4:23 PM



CALCULATED
ATW
CHECKED
JCH

* OR AS SHOWN IN CROSS SECTIONS

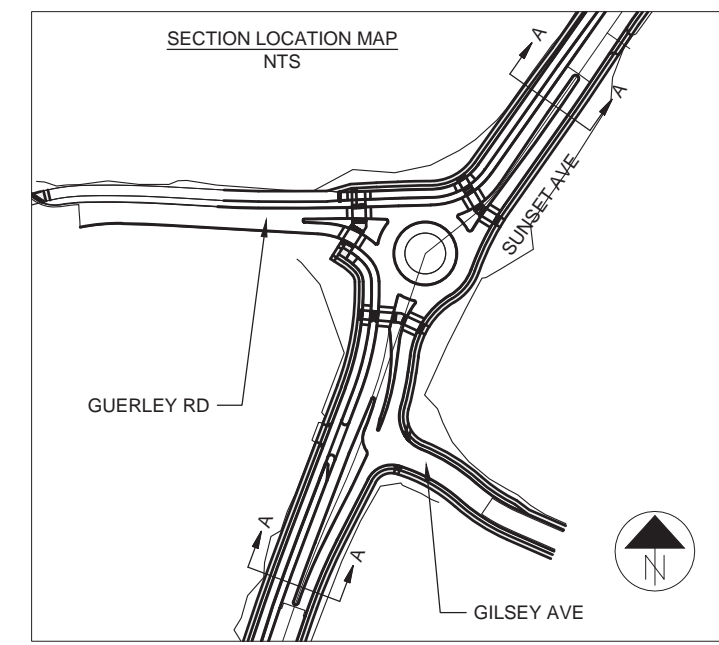
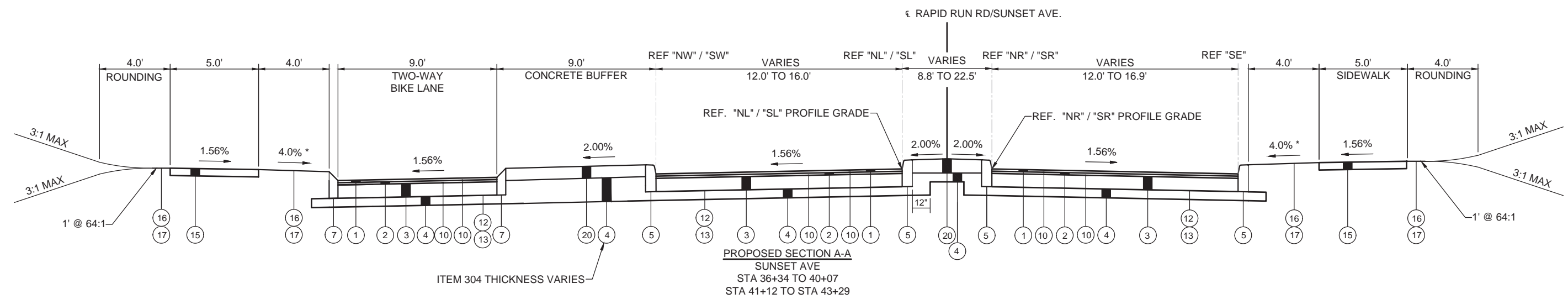

LEGEND

- | | | | |
|--|--|---|--|
| (A) EX. ± 3" ASPHALT PAVEMENT | (1) ITEM 442 - 1.5" ASPHALT CONCRETE SURFACE COURSE, 12.5 MM, TYPE A (448) | (7) ITEM 609 - CURB, ODOT TYPE 10-A, AS PER PLAN | (13) ITEM 204 - PROOF ROLLING |
| (B) EX. ± 12" CONCRETE OR ASPHALT PAVEMENT | (2) ITEM 442 - 1.5" ASPHALT CONCRETE INTERMEDIATE COURSE, 9.5 MM, TYPE A (448) | (8) ITEM 609 - CURB, TYPE 7 | (14) ITEM 422 - AGGREGATE SINGLE CHIP SEAL, TYPE A (SEE LAP JOINT DETAIL) |
| (C) EX. ± 12" CONCRETE PAVEMENT | (3) ITEM 305 - 9" CONCRETE BASE, CLASS QC 1P | (9) ITEM 452 - 8" NON-REINFORCED CONCRETE PAVEMENT, CLASS QC 1P | (15) ITEM 609 - 4" CONCRETE WALK |
| (D) EX. CURB | (4) ITEM 304 - 6" AGGREGATE BASE | (10) ITEM 407 - NON-TRACKING TACK COAT | (16) ITEM 659 - SEEDING AND MULCHING |
| (E) EX. SIDEWALK | (5) ITEM 609 - CURB, TYPE 6, AS PER PLAN (CURB, TYPE S-1, DWG. NO. C103) | (11) ITEM 254 - PAVEMENT PLANING, ASPHALT CONCRETE (2.5" TYP., 0.25" MIN TO 3.5" MAX) | (17) ITEM 659 - 4" TOPSOIL |
| ▨ ITEM 202 - PAVEMENT REMOVED | (6) ITEM 609 - CURB, TYPE 10 | (12) ITEM 204 - SUBGRADE COMPACTION | (18) ITEM 517 - RAILING (CONCRETE PARAPET WITH TWIN STEEL TUBE RAILING), AS PER PLAN |
| | | | (19) ITEM 601 - PAVED GUTTER, MISC.: CONCRETE GUTTER (DETAIL TO BE PROVIDED AT FUTURE SUBMITTAL) |

TYPICAL SECTIONS
PROPOSED SUNSET AVE

LICK RUN CONNECTOR

S:\CIN\3700--3799\Drawings\006\Drawings\CAD\Civil_3d\SheetsPlan\LRC_GY_002.dwg 18-Jul-25 4:23 PM



CALCULATED	ATW	CHECKED	JCH
------------	-----	---------	-----

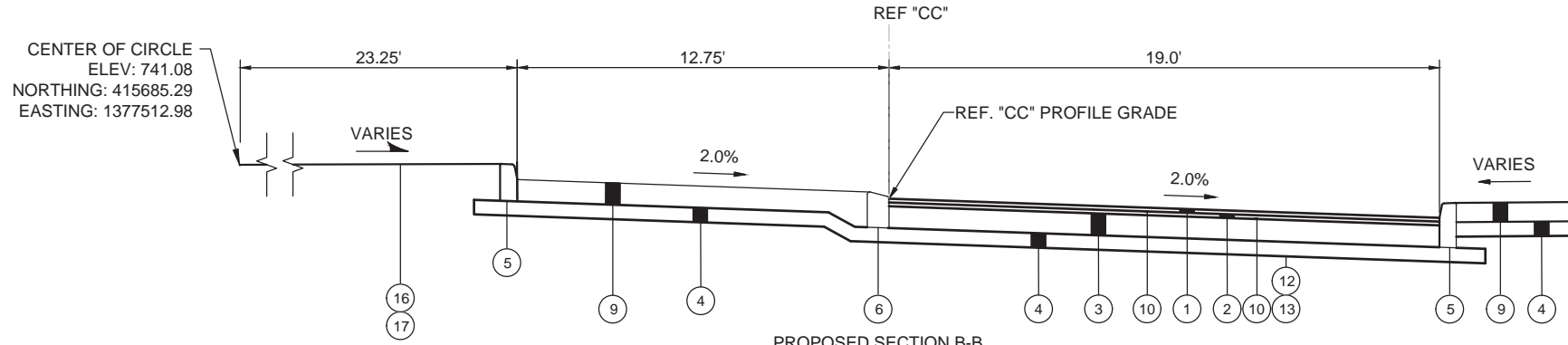

PROPOSED SECTION B-B
CIRCULATORY ROADWAY
STA 3000+41 TO STA 3000+56
STA 3001+33 TO STA 3001+51
STA 3002+04 TO STA 3002+26

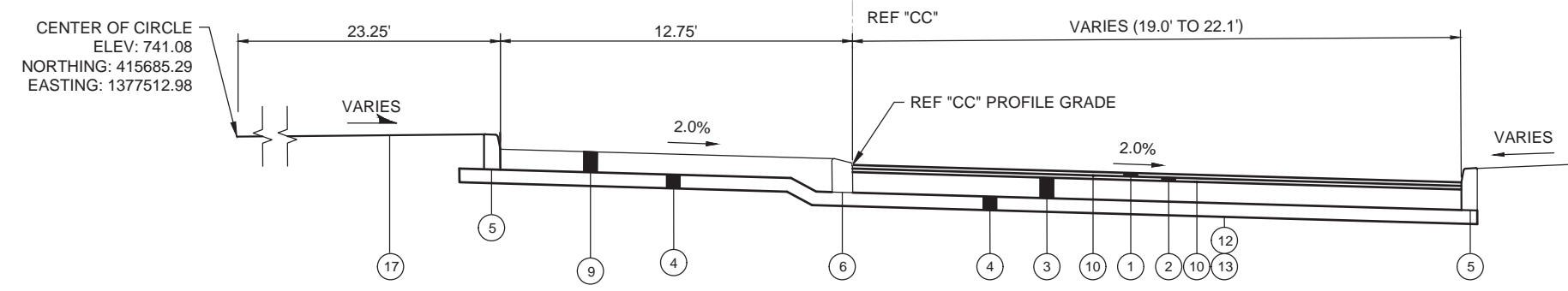

PROPOSED SECTION C-C
CIRCULATORY ROADWAY
STA 3000+00 TO STA 3000+41
STA 3000+56 TO STA 3001+33
STA 3001+51 TO STA 3002+04

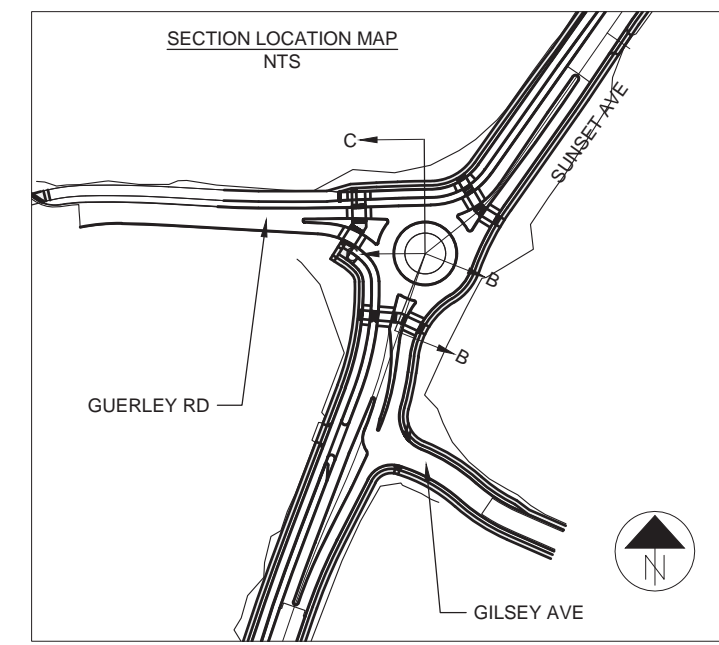
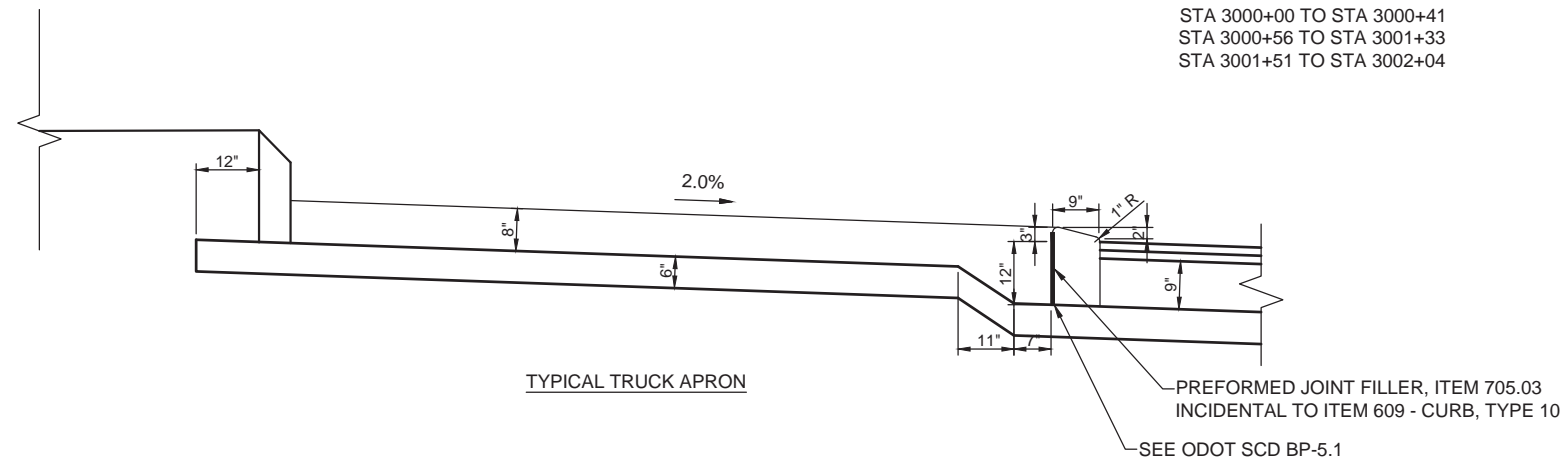

TYPICAL SECTIONS
PROPOSED SUNSET AVE

LICK RUN CONNECTOR

S:\CIN\3700--3799\3731\006\Drawings\CAD\Civil_3d\SheetsPlan\LRC_GY_002.dwg 18-Jul-25 4:23 PM

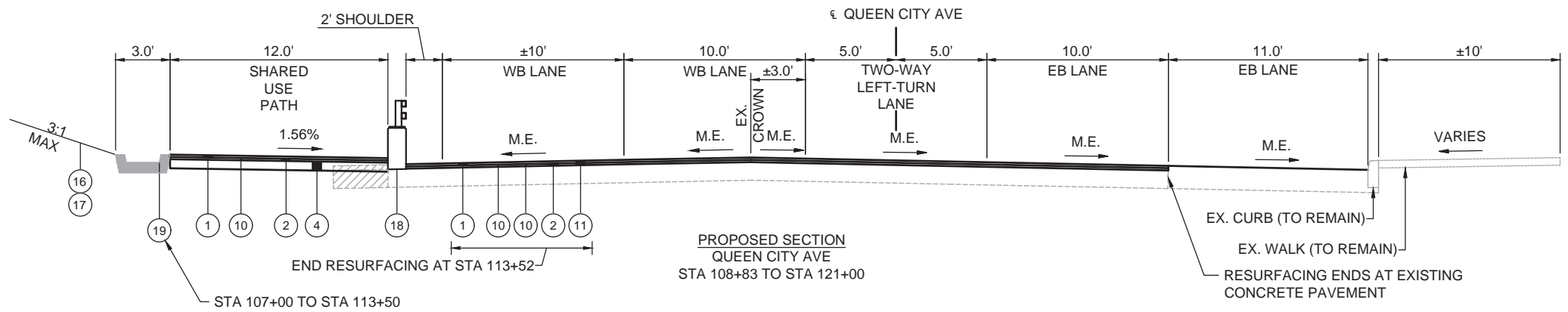
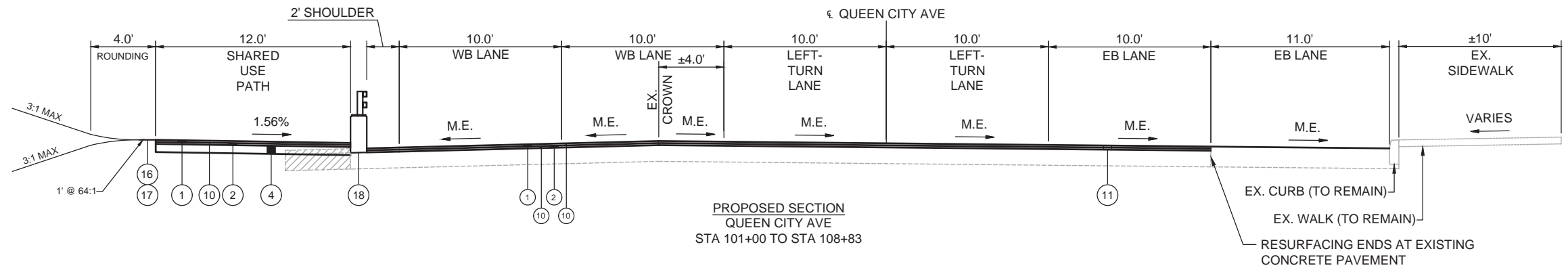

4" WEEP HOLES 5' O.C. AND AT EX. QUEEN CITY AVE INLET LOCATIONS. 4" ORIFICE ELEVATION TO BE 1" BELOW EDGE OF PATH ELEVATION.

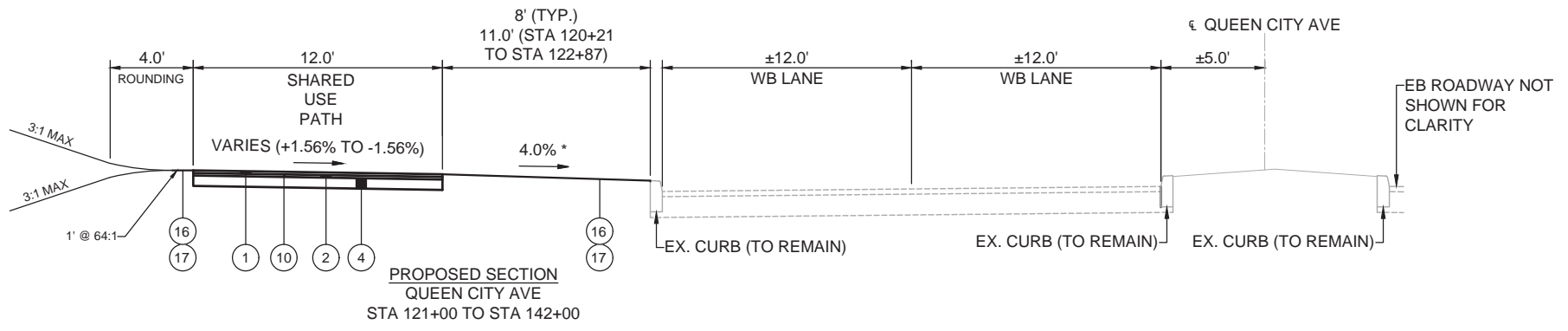
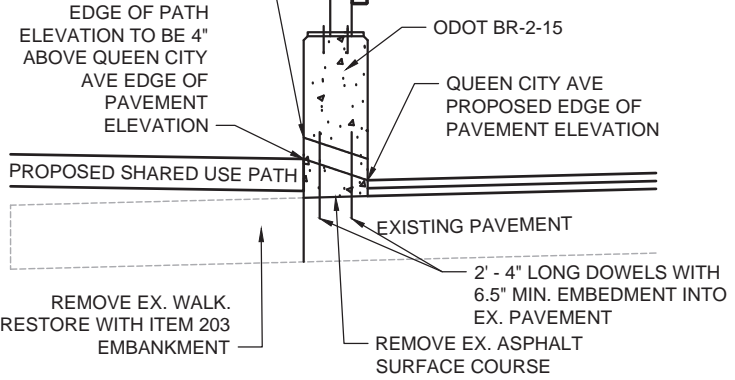

ITEM 517- RAILING (CONCRETE PARAPET WITH TWIN STEEL TUBE RAILING), AS PER PLAN
 • DOWELED INTO EX. PAVEMENT, AS PER PLAN

- | | | | |
|--|--|---|--|
| (A) EX. ± 3" ASPHALT PAVEMENT | (1) ITEM 442 - 1.5" ASPHALT CONCRETE SURFACE COURSE, 12.5 MM, TYPE A (448) | (7) ITEM 609 - CURB, ODOT TYPE 10-A, AS PER PLAN | (13) ITEM 204 - PROOF ROLLING |
| (B) EX. ± 12" CONCRETE OR ASPHALT PAVEMENT | (2) ITEM 442 - 1.5" ASPHALT CONCRETE INTERMEDIATE COURSE, 9.5 MM, TYPE A (448) | (8) ITEM 609 - CURB, TYPE 7 | (14) ITEM 422 - AGGREGATE SINGLE CHIP SEAL, TYPE A (SEE LAP JOINT DETAIL) |
| (C) EX. ± 12" CONCRETE PAVEMENT | (3) ITEM 305 - 9" CONCRETE BASE, CLASS QC 1P | (9) ITEM 452 - 8" NON-REINFORCED CONCRETE PAVEMENT, CLASS QC 1P | (15) ITEM 609 - 4" CONCRETE WALK |
| (D) EX. CURB | (4) ITEM 304 - 6" AGGREGATE BASE | (10) ITEM 407 - NON-TRACKING TACK COAT | (16) ITEM 659 - SEEDING AND MULCHING |
| (E) EX. SIDEWALK | (5) ITEM 609 - CURB, TYPE 6, AS PER PLAN (CURB, TYPE S-1, DWG. NO. C103) | (11) ITEM 254 - PAVEMENT PLANING, ASPHALT CONCRETE (2.5" TYP., 0.25" MIN TO 3.5" MAX) | (17) ITEM 659 - 4" TOPSOIL |
| (Hatched) ITEM 202 - PAVEMENT REMOVED | (6) ITEM 609 - CURB, TYPE 10 | (12) ITEM 204 - SUBGRADE COMPACTION | (18) ITEM 517 - RAILING (CONCRETE PARAPET WITH TWIN STEEL TUBE RAILING), AS PER PLAN |
| | | | (19) ITEM 601 - PAVED GUTTER, MISC.: CONCRETE GUTTER (DETAIL TO BE PROVIDED AT FUTURE SUBMITTAL) |

LEGEND

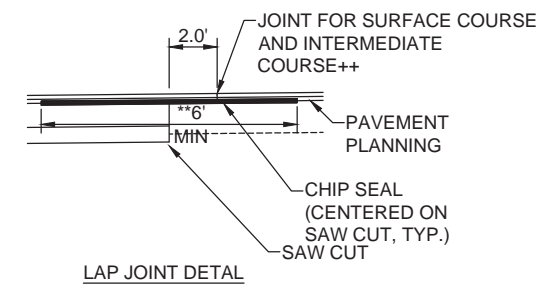

**WIDTH OF CHIP SEAL SHALL BE 4' AT LOCATIONS WHERE WIDTH OF PROPOSED PAVEMENT WIDENING IS 2'.
 ++SURFACE COURSE AND INTERMEDIATE COURSE SHALL BE APPLIED NO LESS THAN 24 HOURS AFTER CHIP SEAL IS APPLIED.

TYPICAL SECTIONS
 PROPOSED QUEEN CITY AVE

LICK RUN CONNECTOR

S:\CIN\3700--3799\3731\006\Drawings\CAD\Civil_3d\SheetsPlan\LRC_GY_002.dwg 18-Jul-25 4:23 PM

